

PLACED IN THE BUILDING COMMITTEE MEETING
HELD ON 08-10-2020. RECOMMENDED

Passed in the meeting of Board of Administrators

Held on 05-01-21

Note: Structural Details shall be followed as per 'Approved' Marked Copy.

CONDITIONALLY APPROVED THE PLAN AND NOTICE REGARDING INSPECTION BEFORE LAY OUT PLAN & CASTING OF FOUNDATION & ROOF CASTING OF BUILDING IS ATTACHED

Valid for Three Years.
From the Date of Sanctioned 26-02-21

THIS PLAN IS CONDITIONALLY SANCTIONED THAT NO OBJECTION CERTIFICATE FROM FIRE SERVICE IS REQUIRED BEFORE OBJECTION OCCUPANCY CERTIFICATE

TIN SHADE GODOWN (HT. APPROX. 3.6 M)

TIN SHADE GODOWN (HT. APPROX. 3.6 M)

TIN SHADE GODOWN (HT. APPROX. 3.6 M)

TIN SHADE GODOWN (HT. APPROX. 3.6 M)

TIN SHADE GODOWN (HT. APPROX. 3.6 M)

TIN SHADE GODOWN (HT. APPROX. 3.6 M)

TIN SHADE GODOWN (HT. APPROX. 3.6 M)

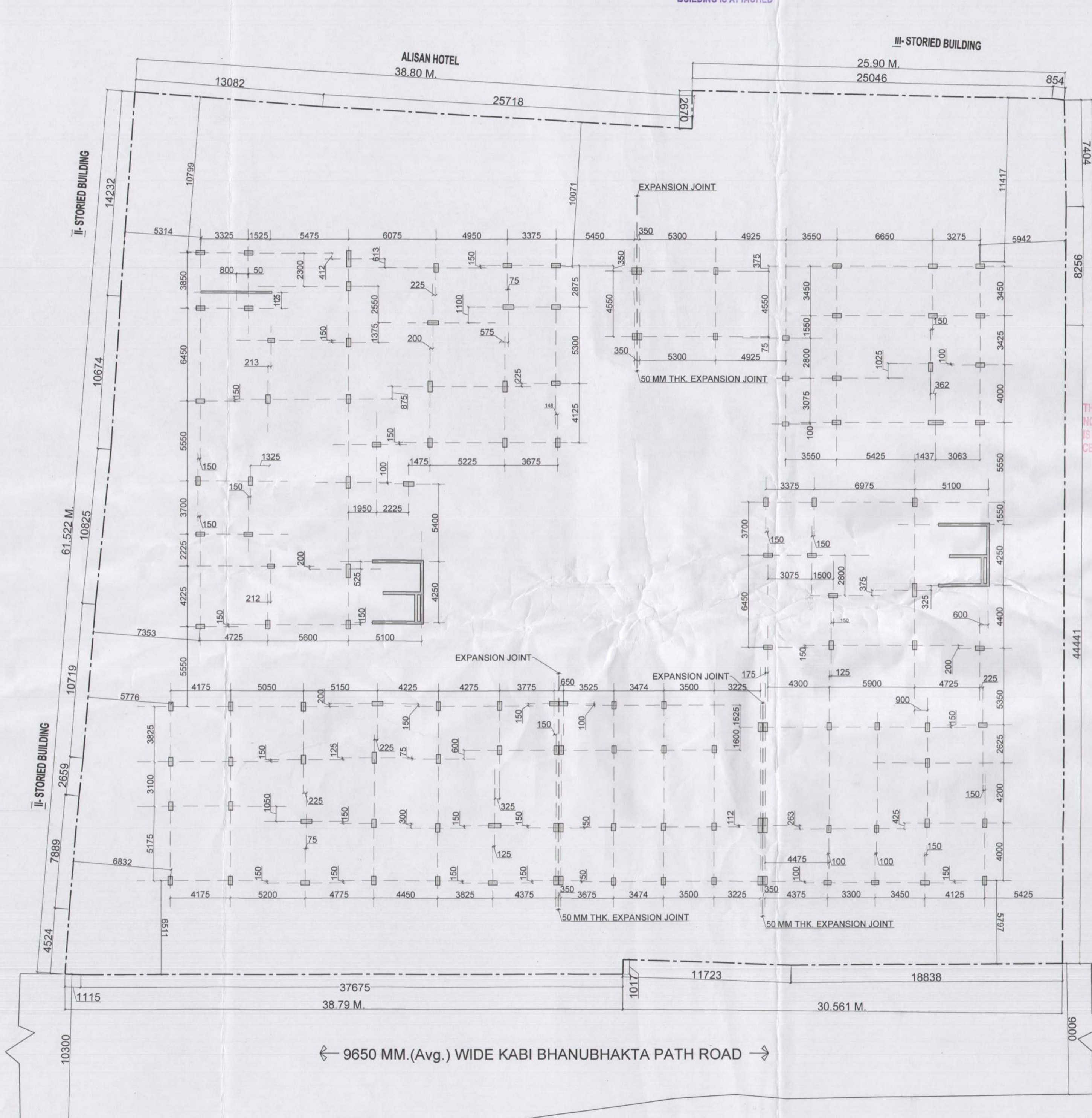

COLUMN LAYOUT
SCALE - 1:200

THIS PLAN IS CONDITIONALLY SANCTIONED THAT NO OBJECTION CERTIFICATE FROM FIRE SERVICE IS REQUIRED BEFORE OBJECTION OCCUPANCY CERTIFICATE

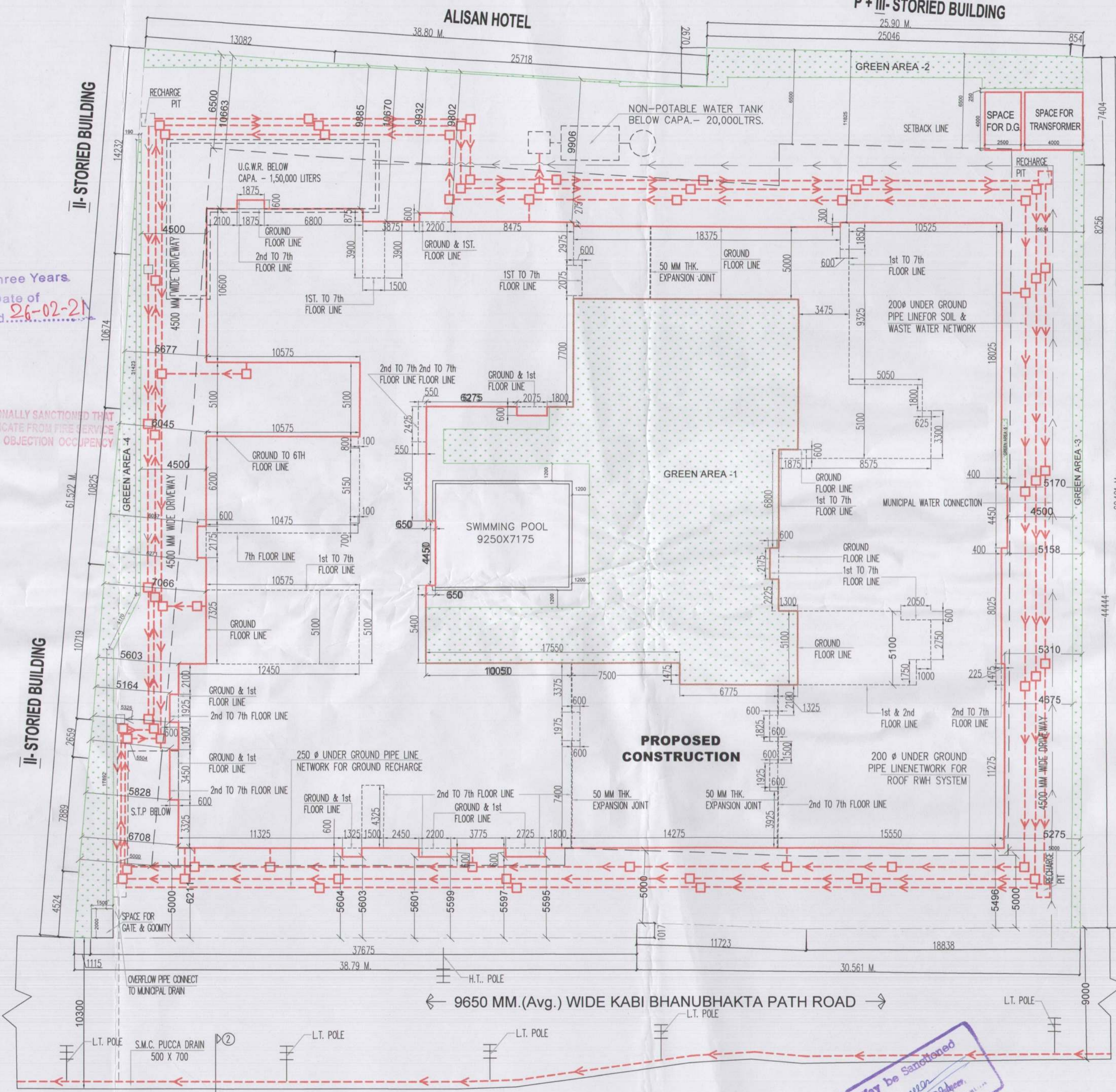

SITE PLAN WITH SERVICES LINE
SCALE - 1:200

SANCTIONED
Asst. Engineer
Siliguri Municipal Corporation

May be Sanctioned
Asst. Engineer
Siliguri Municipal Corporation

ASST. ENGINEER
SILIGURI MUNICIPAL CORPORATION

Executive Engineer
Siliguri Municipal Corporation
18-01-21

PROJECT: PROPOSED GROUND + 7 STORED RESIDENTIAL CUM COMMERCIAL BUILDING.

NAME OF OWNERS: 1. RAVINDAR AGARWAL
2. SURENDRA KR. AGARWAL
3. SIMA AGARWAL
4. BIMLA DEVI AGARWAL
5. JITEN AGARWAL
6. UMESH KUMAR KEDIA
7. KRISHAN KUMAR AGARWAL
8. TANUJ AGARWAL

LOCATION: KABI BHANUBHAKTA PATH, SILIGURI.

SCHEDULE OF LAND:
MOUZA :- DABGRAM
J.L. NO. :- 02
SHEET NO. :- R.S. 8 & L.R. 13
KHATIAN NO. :- R.S. 314,314/5, L.R. 34,35,36,37,38, 162,163,164,165,166
PLOT NO. :- R.S. 421 & L.R. 126,129 & 130
PARGANA :- BAIKANTHAPUR
WARD NO. :- 43
P.S. :- BHAKTINAGAR.
DIST. :- JALPAIGURI.
HOLDING NO. :- N / 56 / 2688, VL / 100 / C/43, 96 / N / 124



GENERAL NOTES:
1. ALL DIMENSIONS ARE IN MILLIMETRES
2. ONLY WRITTEN DIMENSIONS ARE TO BE FOLLOWED.
3. ALL EXTERNAL WALL ARE 200MM THICK AND INTERNAL WALL ARE 125MM THICK UNLESS OTHERWISE NOTED.
4. ALL SHOPS ARE ARTIFICIALLY LIGHTED & MECHANICALLY VENTILATED.
5. GRADE OF STEEL Fe-500 AND GRADE OF CONCRETE M-30.
6. TILES/MARBLE TO BE USED FOR FLOORING.

DECLARATION OF OWNER
I do hereby declare that the building proposed for construction shall be supervised by the B.A. / L.B.S. signing the building plan application or in his absence by any other B.A. / L.B.S. of the Appropriate Category and as approved by the Authority.

SIGNATURE OF OWNER
Ravindra Agarwal, Surendra K. Agarwal, Sima Devi Agarwal, Jiten Agarwal, Umesh Kumar Kedia, Krishan Kumar Agarwal, Tanuj Agarwal

CERTIFICATE OF BUILDING PLAN
I/We do hereby certify that plans, elevations and other structural details of the proposed building on Plot no. - 421(R.S.), 126(L.R.), 129(L.R.), 130(L.R.) Street - Kabi Bhanubhakta Path, Ward no. - 43, under the jurisdiction of S.M.C. have been prepared in conformity with all relevant provisions under the West Bengal Municipal (Building) Rules, 2007. This also to certify that all relevant 'No Objection' Certificate from the respective Authorities such as, Fire & Emergency Services Department, Airport Authority, Pollution Control Board, Telecommunication Department etc. as applicable in this regard, are also enclosed with the application for seeking approval of the plan to construct/reconstruct/ addition to/alteration of the building on the said plot.

SIGNATURE OF ARCHITECT / L.B.S.
MITUL SHUKLA (B. Arch.)
CA/2004/33251

CERTIFICATE OF STRUCTURE STABILITY
I/We do hereby certify that the foundation and superstructure of the proposed building on Plot no. - 421(R.S.), 126(L.R.), 129(L.R.), 130(L.R.) Street - Kabi Bhanubhakta Path, Ward no. - 43, under the jurisdiction of S.M.C. have been personally inspected and also design by me/us will make such foundation and super structure safe in all respect including the consideration of bearing capacity and settlement of soil and other condition, if any, conforming to all stipulations of all relevant IS Code of Practice and National Building Code.

SIGNATURE OF STRUCTURAL ENGINEER
SANJIV J. PAREKH
M.E. (STRUCT.), M.E. (CONST. ENG.)
B.C.E. FILE (F-018202-4)
E.S.E. NO. 10471 K.M.C.C.
SILIGURI MUNICIPAL CORPORATION

SIGNATURE OF GEO-TECHNICAL ENGINEER
(FOR SOIL ONLY)
Surbhi Chatterjee
B.E. (CIVIL), M.E.
Geo-Technical Engineer, Class I
Hospital Road, Near Calcutta Park
SILIGURI MUNICIPAL CORPORATION

SHEET NO. 10/10

RESIDENCE ARCHITECT:-
GREEN ARCHITECTURE CONSULTING ENGINEERS PVT. LTD.

1ST FLOOR, B.R. AMBEDKAR COMPLEX, HILL CART ROAD, SILIGURI - 734003

DRAWN BY: RATAN
CHECKED BY: MITUL SHUKLA
DATE: 17.01.2019
SCALE: 1:200

ARCHITECT:-
MASS & VOID ARCHITECTS/INTERIORS
4B, 4th Floor, Ektaa Hibiscus, 56, Christopher Road, Kolkata 700 046
P +91 33 2328 2264
+91 90 3800 3186
E mava2003@gmail.com
W www.massandvoid.com